

# Cutting Dies – Tool Steel

## Model C0024

*a measurable difference...*

# IDM<sup>®</sup>

## instruments

The Tool Steel Cutting Dies are used for the cutting of plastics, paper, textiles and rubber samples. They can be used along with IDM cutting presses for sample preparation.

### Applications:

- Cardboard
- Foam
- Paper
- Plastic
- Rubber

### Features:

- Able to be resharpened
- Longer service life than ruler dies

### Standards:

- BS 2782-3
- AS 1683.11
- AS 2282.7
- ASTM D470
- ASTM D1004
- ASTM D1822
- ASTM D638
- ISO 34-1
- ISO 527
- ISO 6259
- K6301
- ASTM D882
- AS 1301.404
- AS 1180.2
- ASTM D412
- ASTM D624
- ASTM 1660.2
- ASTM D3574
- AS 1145
- ISO 37
- ISO 1798
- K6251
- AS/NZS 1660.2.3

- \* Please specify which cutting die is required
- \* Refer diagrams below to select type
- \* Supply IDM with specifications for custom die

### Options:

- Custom Dies – on request
- Cutting Die Adaptors
- Cutting Press
- Certification

### Dimensions:

- Refer diagrams below



Can be used with the following Cutting Presses



C0022



C0050



S0003



Cutting Die Adaptor

All dimensions in mm

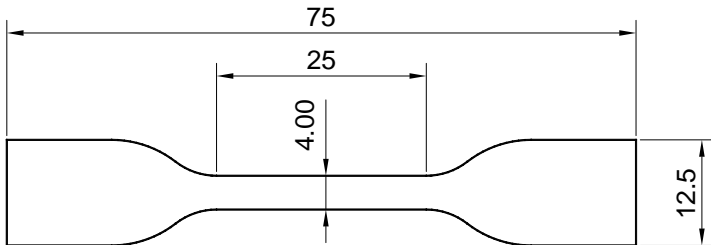

### C0024 – Type A

- ISO 37-Type 2
- ISO 527-2-Type 5A
- AS 1145-Type 5A
- K6251-Type 6
- AS/NZS 1660.2.3
- DIN53504

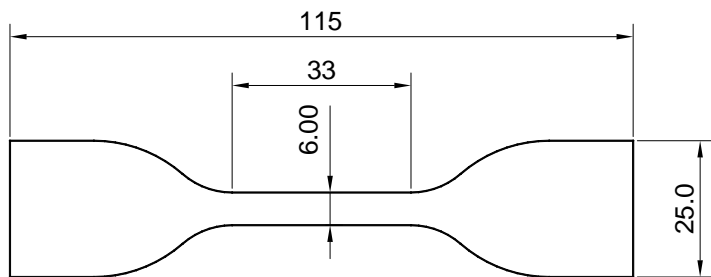

### C0024 – Type B

- ASTM D412-C
- ISO 6259-3-Type 2
- K6251-Type 5
- ISO 37 – Type 1
- ISO 527-3 – Type 5
- BS 2782-3 (Method 320A)
- AS 1145.3 – Type 5
- DIN53504
- ASTM D882

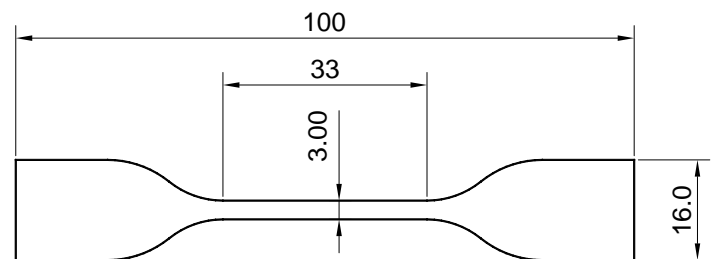

### C0024 – Type C

- ASTM D412-D

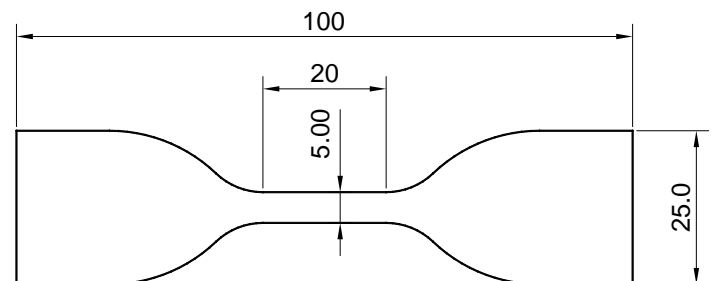

### C0024 – Type D

- JIS K6301-Type 3
- K6251- Type 3
- ISO 37 – Type 1A

All dimensions in mm

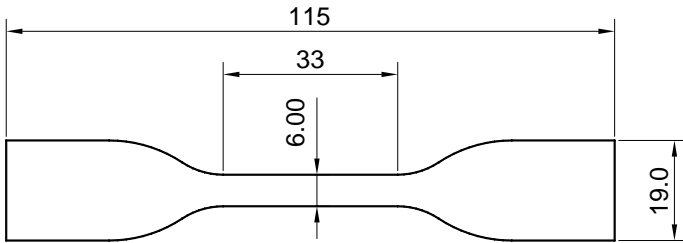

C0024 – Type E

- ASTM D638-02a-Type 4
- ASTM D6693

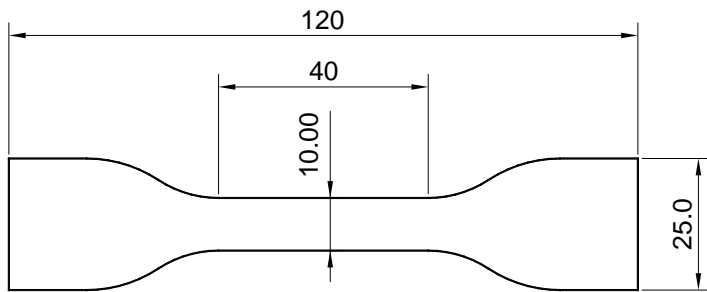

C0024 – Type F

- JIS K6301-Type 1

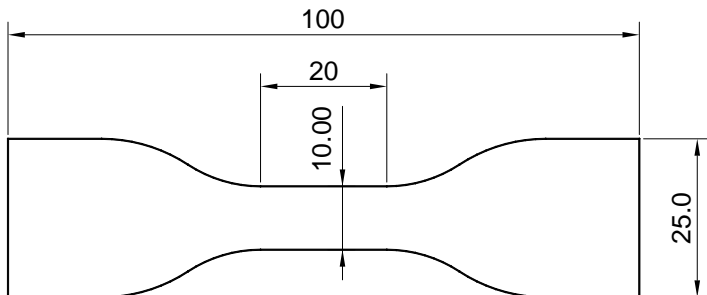

C0024 – Type G

- JIS K6301-Type 2

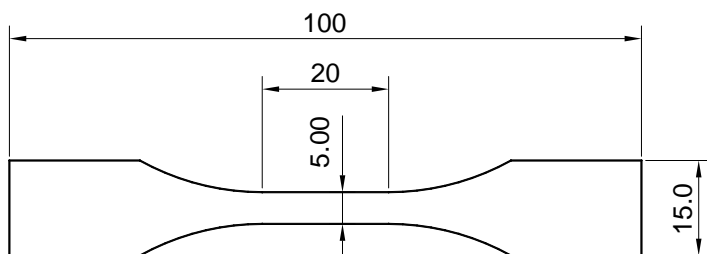

C0024 – Type H

- JIS K6301-Type 4

All dimensions in mm

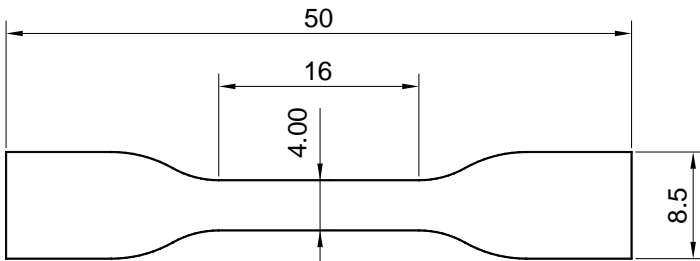

C0024 – Type I

- ISO 37 – Type 3
- AS/NZS 1660.2.3
- DIN 53504

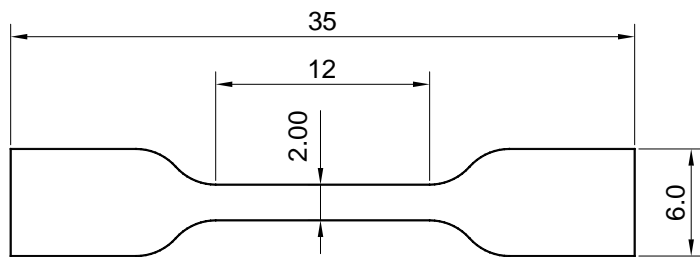

C0024 – Type J

- ISO 37 – Type 4
- ISO 527-2 – Type 5B

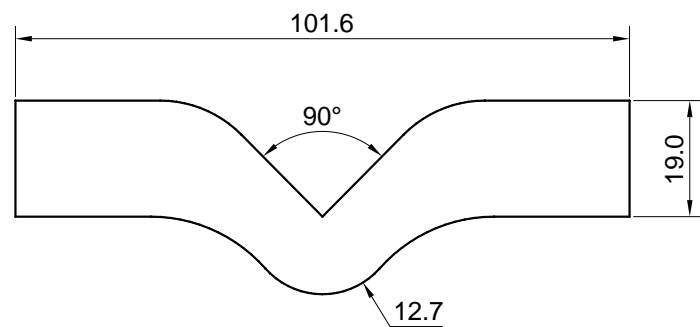

C0024 – Type K

- K6301- B
- ASTM D624 – Type C
- ASTM D1004-03
- DIN ISO34-1

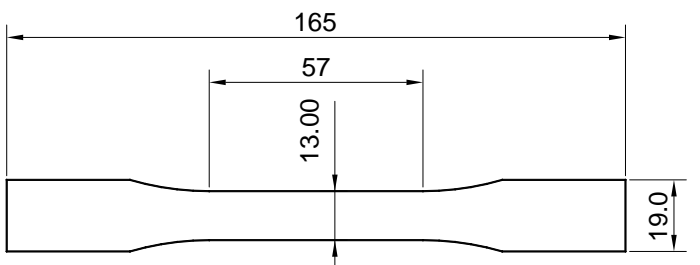

C0024 – Type L

- ASTM D638-02a-Type 1

All dimensions in mm

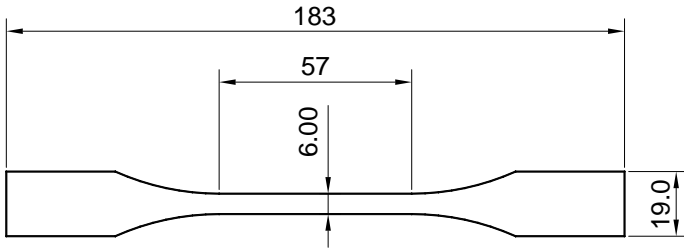

C0024 – Type M

- ASTM D638-02a-Type 2

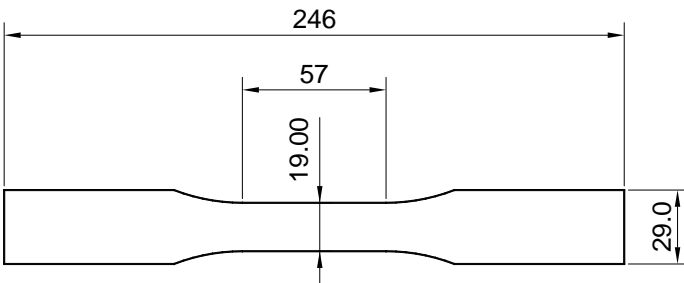

C0024 – Type N

- ASTM D638-02a-Type 3

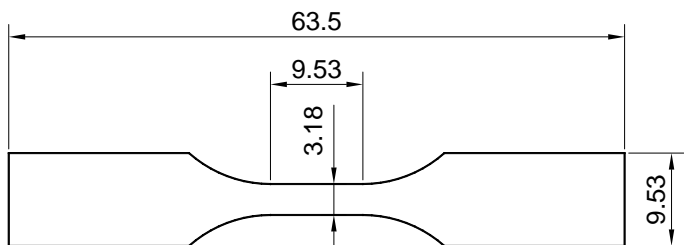

C0024 – Type O

- ASTM D638-02a-Type 5

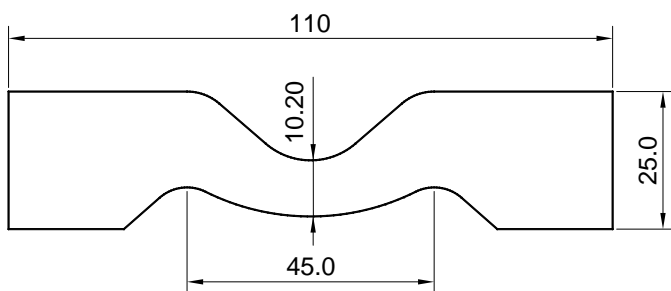

C0024 – Type P

- DIN ISO 34-1
- K6301-Type A
- ASTM D624 – Type B

All dimensions in mm

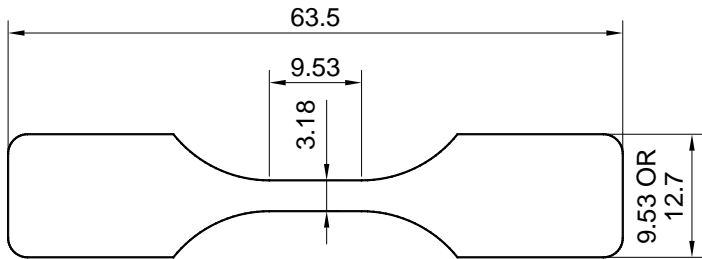

C0024 – Type Q

- ASTM D1822-Type L

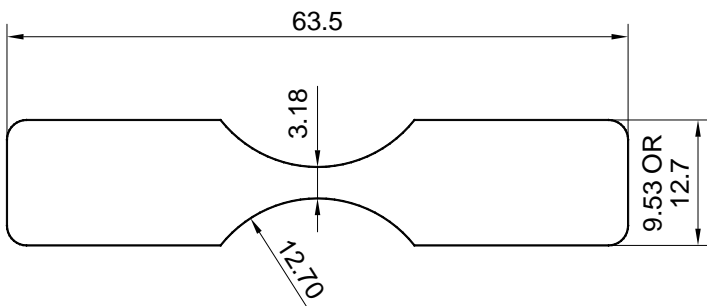

C0024 – Type R

- ASTM D1822-Type S

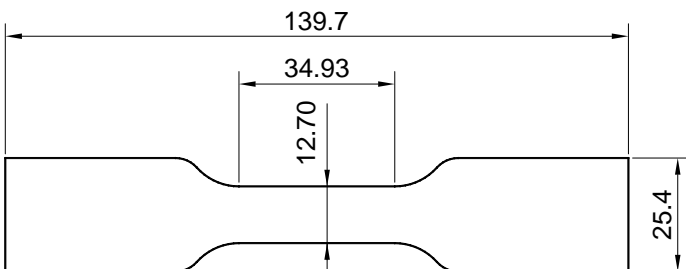

C0024 – Type S

- ASTM D3574 – Type E

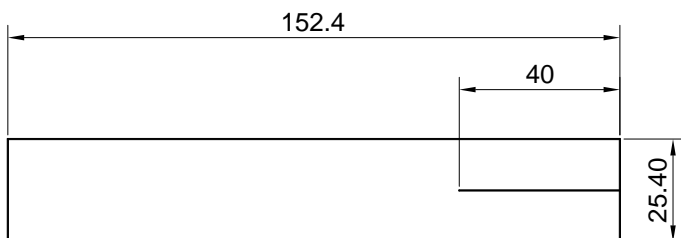

C0024 – Type T

- ASTM D3574 – Type F
- DIN ISO34-1

All dimensions in mm

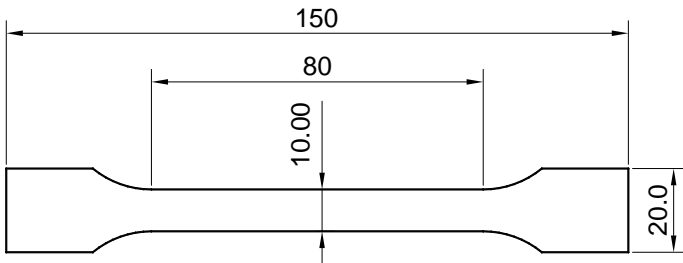

C0024 – Type U

- ISO 527-2 – Type 1A

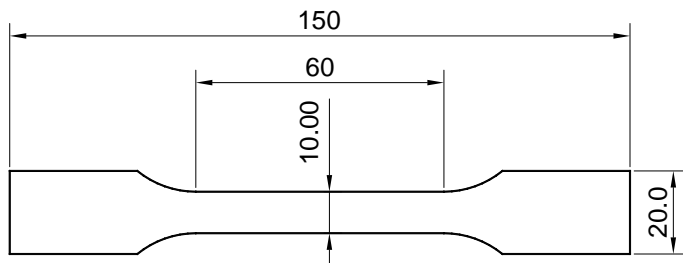

C0024 – Type V

- ISO 527-2 – Type 1B
- ISO 527-3 – Type 1B
- BS 2782-3 (Method 320B)
- BS 2782-10 – Type 1
- ISO 6259-3 Type 1

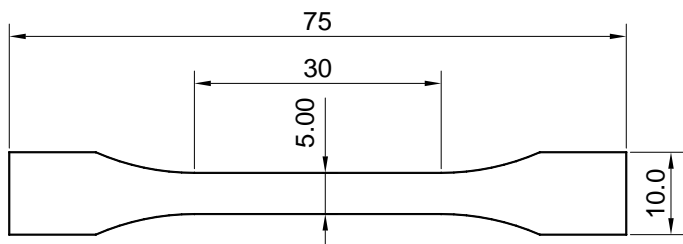

C0024 – Type W

- ISO 527-2 – Type 1BA

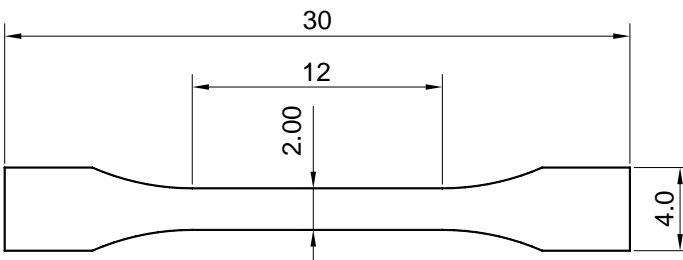

C0024 – Type X

- ISO 527-2 – Type 1BB

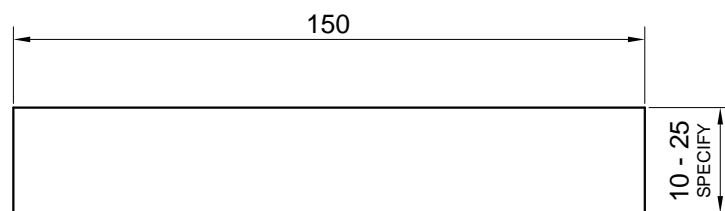

C0024 – Type Y

- ISO 527-3 – Type 2
- AS 1145.2 – Type 2

All dimensions in mm

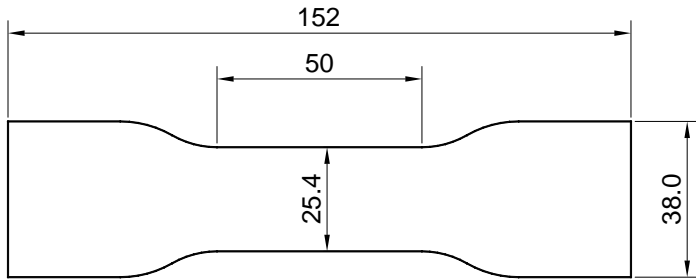

C0024 – Type Z

- ISO 527-3 – Type 4

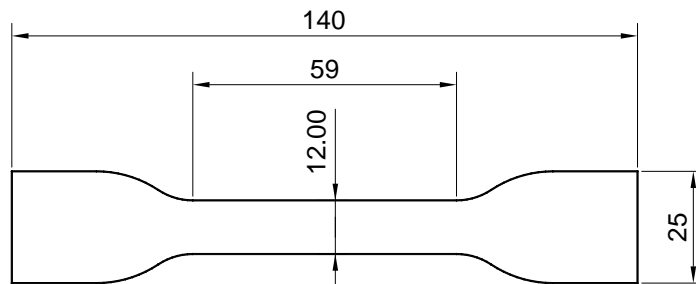

C0024 – Type Aa

- ASTM D412 – Type A

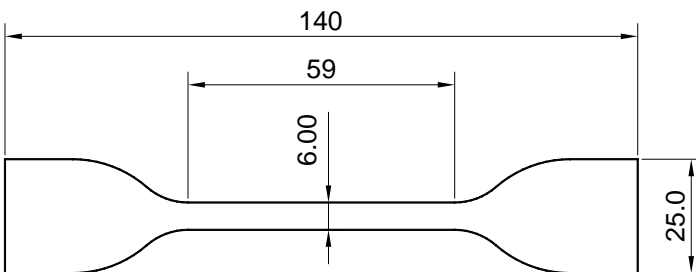

C0024 – Type Ab

- ASTM D412 – Type B

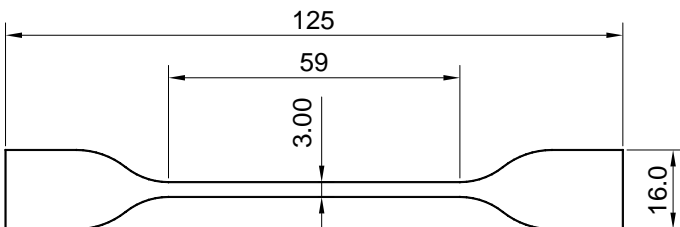

C0024 – Type Ac

- ASTM D412 – Type E

All dimensions in mm



# Cutting Dies – Tool Steel

## Model C0024

*a measurable difference...*

**IDM**®  
instruments

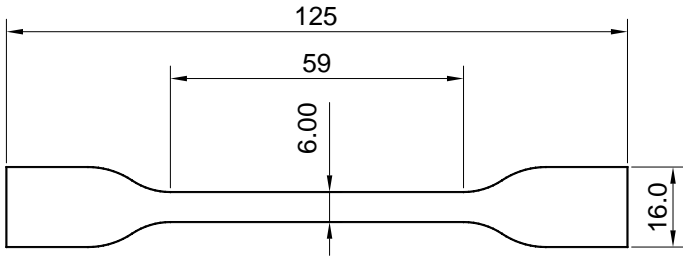

C0024 – Type Ad

- ASTM D412 – Type F

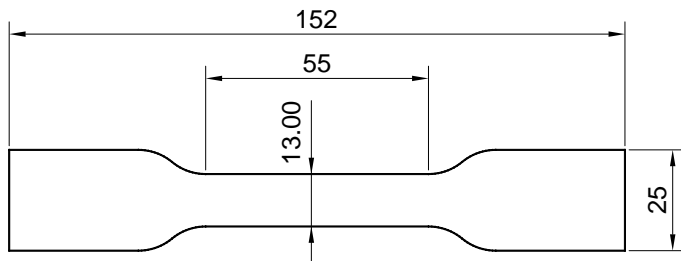

C0024 – Type Ae

- ISO 1798

*\* Other custom dies are available upon request*

All dimensions in mm